

FUNCTIONAL DESCRIPTION

- ① Single head
- ② Dual head
- ③ Extension poles
- ④ Extension release bracket
- ⑤ Control panel
- ⑤-① Brightness
- ⑤-② Battery level
- ⑤-③ Power
- ⑤-④ AC Indicator light
- ⑥ Handles
- ⑦ USB Output
- ⑧ AC plug (Only for Dual head)
- ⑨ Leg release button
- ⑩ Legs
- ⑪ Carrying handle
- ⑫ Battery bay
- ⑬ DC input port

SPECIFICATIONS

Model	Single head	Dual head
Lumens	0 - 4,000Lm	0 - 12,000Lm
Power Supply	D24 series battery pack	D24 series battery pack / AC 100-277V
Weight	5.9Kg (Fitting only)	6.3Kg (Fitting only)
Hight		1~2.3m
Run Times		>8hours (Standard mode, D24-100)
IP Grade		IP66
Output(USB)		5V 2A(2 Dock)

Inserting/Removing Battery Packs

WARNING Recharge only with the charger specified for the battery. For specific charging instructions, read the operator's manual supplied with your charger and battery.

To insert the battery, slide the pack into the body of the light tower. Make sure it latches securely into place.

To remove the battery, push in the release buttons and pull the battery pack away from the light tower.

Always lock the trigger or remove the battery pack any time the light tower is not in use.

NOTE: Always ensure the battery door gasket is clean and clear of dirt and debris. Close the battery door latches securely to ensure water cannot enter the battery compartment.

Electricity

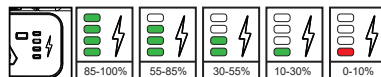

Use the Fuel Gauge to determine the light tower remaining run time.
NOTE: When the battery is about to run out, the light tower will flash slowly.

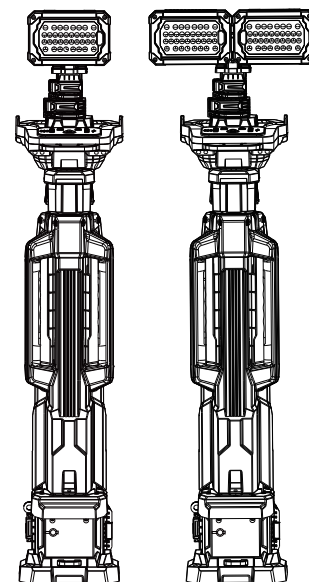

OPERATOR'S MANUAL

WARNING

TO REDUCE THE RISK OF INJURY,
USER MUST READ AND UNDERSTAND
OPERATOR'S MANUAL.

SYMBOLGY

- V Volts
- AC Power
- Direct Current
- Do Not Stare Into Light !

IMPORTANT SAFETY INSTRUCTIONS

WARNING

Read and understand all instructions. When using electric appliances, basic precautions should always be followed, including the following:

- Before using, read this operator's manual, your battery pack and charger operator's manual, and all labels on the battery pack, charger, and light. Learn your light's applications and limitations as well as potential hazards associated with this type of tool.
- Read and understand all the instructions before using the appliance.
- To reduce the risk of injury, close supervision is necessary when any appliance is used near children.
- Warning - The lens may get hot during use. To reduce the risk of burns, do not touch hot lenses.
- Store idle light out of reach of children. Warm lights can become hazardous in the hands of children.
- Suitable for rain and wet locations. Store indoors.
- Use light only with a specifically designated battery pack. The use of any other batteries may create a risk of fire.
- Batteries must be recharged only with the charger specified by the manufacturer. A charger that may be suitable for one type of battery may create a risk of fire when used with another battery.
- Do not use a battery pack or tool that is damaged or modified. Damaged or modified batteries may exhibit unpredictable behavior resulting in fire, explosion, or risk of injury.
- When the battery pack is not in use, keep it away from metal objects like paper clips, coins, keys, nails, screws, or other small metal objects that can make a connection from one terminal to another. Shorting the battery terminals together may cause sparks, burns, or a fire.
- Do not expose a battery pack or tool to fire or excessive temperature. Exposure to fire or temperature above 265°F (130°C) may cause an explosion.
- Under abusive conditions, liquid may be ejected from the battery; avoid contact. If contact accidentally occurs, flush with water. If liquid contacts the eyes, additionally seek medical help. Liquid ejected from the battery may cause irritation or burns.
- Follow all charging instructions and do not charge the battery pack or tool outside the temperature range specified in the instructions. Charging improperly or at temperatures outside the specified range may damage the battery and increase the risk of fire.
- Never service damaged battery packs. Service of battery packs should only be performed by the manufacturer or authorized service providers.

ASSEMBLY



WARNING

To reduce the risk of injury, do not look directly into the light when the light is on.
To reduce the risk of injury, always fully extend and lock legs into position before raising the poles.
To reduce the risk of injury, keep hands clear of the housing area when collapsing the extension poles. Head may descend rapidly, pinching hands and fingers.

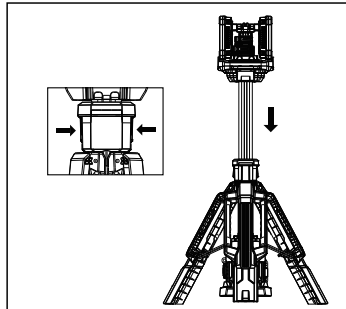

Extending/Collapsing the Legs

Always extend and lock legs before raising the poles.

1. Stand light upright.
2. Press the Leg Release Button and lift up on the Upper Handle while sliding down the Carrying Handle.
3. Lift until the Battery Bay lifts off the floor and the legs lock into place.
4. To collapse, press the Leg Release Button and slide in the legs using the Carrying Handle.

Adjust the lamp head

Use a 3.0mm hexagonal wrench to adjust the tightness of the lamp head.

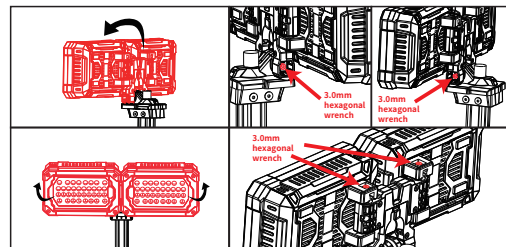

Extending/Collapsing the Extension Poles

Extend or collapse the two poles to set the light at the desired height.

1. Extend and lock the legs.
2. Raise the head and Rotate the head to the desired angle.
2. Open the top extension latch and extend the pole to the desired height.
3. Fully close top extension latch.
4. If more height is needed, fully extend first pole and close latch before opening bottom latch.
5. Continue to raise the head to the desired height.
6. Fully close bottom extension latch.

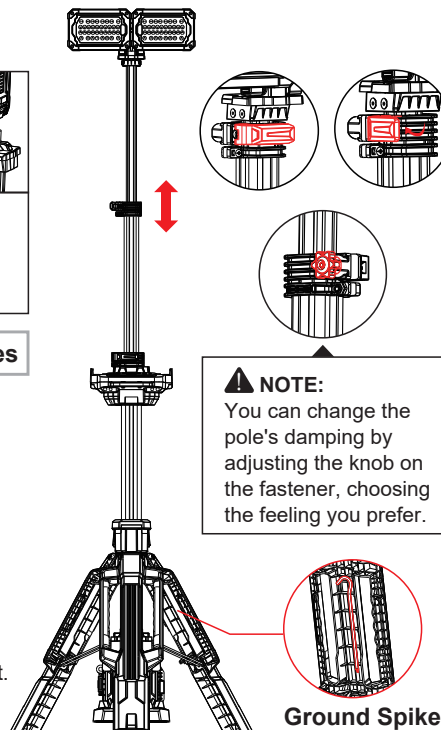

NOTE:
You can change the pole's damping by adjusting the knob on the fastener, choosing the feeling you prefer.

Ground Spike

OPERATION



WARNING To reduce the risk of injury, do not look directly into the light when the light is on.

Using the Light - Battery Packs

1. Insert battery pack. Close and latch the battery door.
2. Turn on the switch to enter Eco mode. Press the switch button again to cycle through Balanced, Standard, and Turbo modes. Press the button again to turn off.

Charging your mobile devices

Open the soft cover and connect your mobile device with USB plug which compatible with 5V 2A DC input current.

Using the Light - Driver (Only for Dual head)

To operate the light on AC power, extend and lock legs. Plug a suitable extension cord into the AC inlet. To disconnect the extension cord, press the switch button to turn off the light, then remove the cord from the inlet.

NOTE: When an extension cord is plugged into the light, the light will automatically run on AC power.

Using the Light - DC

The battery in the light tower is charged through the external output line of the charger, and the luminaire can work simultaneously.

NOTE: When the external input cable of the charger is plugged into the light, the light will automatically run on DC power.

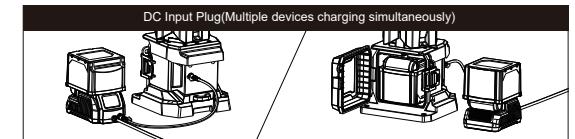
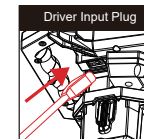
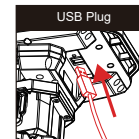

MAINTENANCE



WARNING

To reduce the risk of injury, always unplug the charger and remove the battery pack from the charger or tool before performing any maintenance. Never disassemble the tool, battery pack or charger.

Maintain Light

Keep your light, battery pack and charger in good repair by adopting a regular maintenance program. If the light does not work properly, return the light to service facility for repairs.



WARNING

To reduce the risk of personal injury and damage, never immerse your tool, battery pack or charger in liquid or allow a liquid to flow inside them.

Cleaning

Clean dust and debris from vents. Keep handles clean, dry and free of oil or grease. Use only mild soap and a damp cloth to clean, since certain cleaning agents and solvents are harmful to plastics and other insulated parts. Do not use sprays or solvents. Some of these include gasoline, turpentine, lacquer thinner, paint thinner, chlorinated cleaning solvents, ammonia and household detergents containing ammonia. Never use flammable or combustible solvents around tools.

ACCESSORIES



WARNING

Use only recommended accessories. Others may be hazardous. For a complete listing of accessories.